

FENCE ORDINANCE OF THE CITY OF WYANDOTTE, MICHIGAN

Section 10-1. Authorized. Each person, being the owner of property in the City, may construct and maintain partition fences between his own and the next adjoining property, such partition fences shall be constructed of posts sunk in the soil to a depth of at least two (2) feet, and of a height above the surface of not less than three (3) feet or heights or locations of which would not be in violation of the Wyandotte Zoning Ordinance.

- (a) Owners of adjacent lots may amicably agree upon the character of their partition fences, and the proportion in which they shall bear the expenses thereof. (Cross Reference Zoning Appendix A.)

NOTE: ARTICLE XIX SEC. 1900-7-b OF THE WYANDOTTE ZONING ORDINANCE ALLOWS THAT "FENCES" NOT EXCEEDING FIVE (5) FEET IN HEIGHT MAY OCCUPY A SIDE YARD. "FENCES" NOT EXCEEDING SIX (6) FEET IN HEIGHT MAY OCCUPY A REAR YARD.

Section 10-2. Spikes and nails prohibited. No person, being the owner, occupant or lessee of any building, lot, or premises in the City, shall erect or maintain on or about the stairway to the entrance of such building, or on or about its exterior building line, or upon any portion of the sidewalk or any public place adjacent to such building, any railing, fence, guard, or other protection on which there shall be affixed, or placed, or in any manner attached, any spike, nail, or other pointed instrument or object of any kind or description. No such person shall erect any partition fence upon which any such pointed instrument shall be affixed, placed, or in any manner attached.

Section 10-3. Barbed wire.

- (a) Residentially Zoned Property - No person shall place or maintain any barbed wire fencing or any strands of barbed wire.
- (b) Commercial & Industrial Zoned Property - No person shall place or maintain any barbed wire fencing or any strands of barbed wire along the line of, or in any public street, alley, sidewalk or other public place within the City, nor shall any person build or maintain any line fence composed wholly or partly of barbed wired.

FENCED
CORNER LOT OR LOT ABUTTING ALLEY

& ALLEY

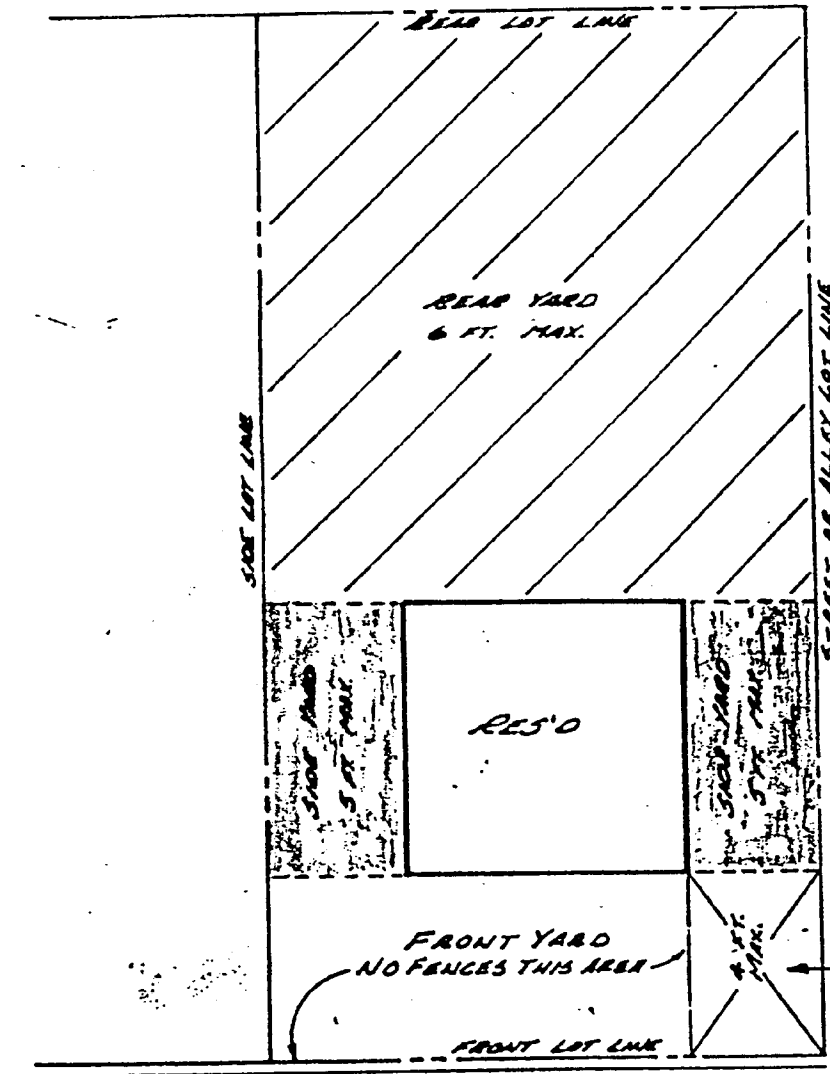

NOTE:
FENCES IN THIS AREA
REQUIRE APPROVAL BY
THE ENG. DEPT. PRIOR
TO INSTALLATION.

STREET

TYPE OF FENCE _____
(HT., MATERIAL, ETC.) _____

LOCATED AT _____

APPROVED BY _____

City of Wyandotte

Michigan

JAMES R. DESANA, MAYOR

DEPARTMENT OF ENGINEERING
MARK A. KOWALEWSKI
CITY ENGINEER
3131 BIDDLE AVENUE

TELEPHONE
246-4450
FAX
246-4498

ZONING ORDINANCE CITY OF WYANDOTTE

Section 1900

7. b. Fences, not exceeding five (5) feet in height may occupy a side yard. Fences not exceeding six (6) feet in height may occupy a rear yard. (Am. 1-25-71)
- (1) No residential fence or wall shall be erected in a required front yard, except, that on lots with a side lot line adjacent to an alley or a street, a decorative or ornamental fence shall be allowed, such as, but not limited to, a split-rail or a two-rail fence; but not to include chain link or fences of solid-type construction and not exceeding four (4) feet in height, may be constructed along the alley, street line, or extension of the side yard to the front of said lot.
 - (2) Decorative or ornamental fences constructed under this section shall not be intended to enclose or be capable of enclosing animals or human beings.
 - (3) Prior to construction of any decorative or ornamental fence allowed by this section, a site plan showing the location and type of fence to be constructed shall be submitted to the department of engineering and building for approval.
 - (4) No decorative or ornamental fence shall be constructed without first obtaining the approval set forth herein. (Am. Ord. No. 870, Section 1, 10-9-89)